

SPECIAL EXHIBITION  
**TŌFUKU-JI**  
 MONUMENTAL ZEN TEMPLE OF KYOTO

List of Works

March 7–May 7, 2023  
 Heiseikan, Tokyo National Museum



**Organizers:** Tokyo National Museum, Tōfuku-ji Temple, The Yomiuri Shinbun, NHK, NHK Promotions Inc., Agency for Cultural Affairs, Government of Japan

**With the special sponsorship of:** Canon Inc., Daiwa Securities Group, Mitsui Fudosan Co., Ltd., MITSUBISHI ESTATE CO., LTD., Meiji Holdings Co., Ltd.

**With the sponsorship of:** East Japan Railway Company, SHIMIZU CORPORATION, TAKENAKA CORPORATION, Sumitomo Mitsui Banking Corporation, Mitsubishi Corporation

A part of the proceeds from the exhibition will be used in a scheme under the TSUMUGU Project to help repair Japan's cultural properties.

**With the support of:** LIVE Art Books Inc.



**Notes**

- The exhibition will also be held at the Kyoto National Museum from October 7 to December 3, 2023.
- The same artwork numbers are used in both the catalogue and the galleries, but the works are not displayed in numerical order. Missing numbers from the list below indicate works exhibited exclusively at the Kyoto venue.
- Key to symbols on illustrations: ● = National Treasure, ◎ = Important Cultural Property.
- Some artworks may be rotated during the exhibition period. Exhibition lineup may change as circumstances require.

- Works are on view throughout the exhibition period unless otherwise indicated.

The rotation schedule is as follows.

- Term**
- |                        |                       |
|------------------------|-----------------------|
| ① 3/7(Tue.)–12(Sun.)   | ⑥ 4/11(Tue.)–16(Sun.) |
| ② 3/14(Tue.)–19(Sun.)  | ⑦ 4/18(Tue.)–23(Sun.) |
| ③ 3/21(Tue.)–27(Mon.)  | ⑧ 4/25(Tue.)–30(Sun.) |
| ④ 3/28(Tue.)–4/2(Sun.) | ⑨ 5/1(Mon.)–7(Sun.)   |
| ⑤ 4/4(Tue.)–9(Sun.)    |                       |

No.	Title	Author etc.	Period / Century	Owner	Term
<b>Chapter 1: Enni and the Founding of Tōfuku-ji Temple</b>					
1	◎ Enni	Inscription by Enni	Kamakura period, dated 1279	Manju-ji Temple, Kyoto	⑤–⑨
2	◎ Enni	Inscription by Enni	Kamakura period, dated 1280	Tōfuku-ji Temple	①–④
3	Enni	Inscription by Enni	Kamakura period, dated 1280	Tōfuku-ji Temple	⑤–⑨
4	Enni	Inscription purportedly by Wuxue Zuyuan	Kamakura–Nanbokuchō period, 13th–14th century	Tōfuku-ji Temple	①–④
6	◎ Enni		Kamakura period, 13th century	Tōfuku-ji Temple	①–④
7	◎ Enni	Inscription by Kenpō Shidon	Nanbokuchō period, 14th century	Tōfuku-ji Temple	⑤–⑨
8	◎ Certificates of Entrance into the Buddhist Priesthood		Kamakura period, dated 1219	Tōfuku-ji Temple	①–④
9	◎ Certificates of Ordination		Kamakura period, dated 1219	Tōfuku-ji Temple	⑤–⑨
10	◎ The Chinese Characters for “Enni”	By Wuzhun Shifan	Southern Song dynasty, China, 13th century	Tōfuku-ji Temple	①–④
11	◎ The Chinese Characters for “Enni”	By Wuzhun Shifan	Southern Song dynasty, China, 13th century	Tōfuku-ji Temple	⑤–⑨
12	● Wuzhun Shifan	Inscription by Wuzhun Shifan	Southern Song dynasty, China, dated 1238	Tōfuku-ji Temple	①–④
13	◎ Wuzhun Shifan	Inscription by Shigu	Southern Song dynasty, China, dated 1254	Tōfuku-ji Temple	⑤–⑨
15	● Certificate of Spiritual Achievement Issued to Enni	By Wuzhun Shifan	Southern Song dynasty, China, dated 1237	Tōfuku-ji Temple	⑤–⑨
16	◎ Large Sect Lineage Chart		Southern Song dynasty, China, dated 1238	Tōfuku-ji Temple	⑤–⑨
18	◎ Sect Lineage Chart	[1] By Wuzhun Shifan [2] By Enni	[1] Southern Song dynasty, China, 13th century [2] Kamakura period, 13th century	Tōfuku-ji Temple	①–④
19	● Letter to Enni (“Calligraphy on the Gift of Timber”)	By Wuzhun Shifan	Southern Song dynasty, China, dated 1242	Tokyo National Museum	①–④
20	◎ Letter to Enni	By Defu	Southern Song dynasty, China, 13th century	Tokyo National Museum	①–④
21	◎ Death Verse (J. <i>Yuige</i> )	Original by Wuzhun Shifan	Southern Song dynasty, China, 13th century	Tōfuku-ji Temple	⑤–⑨
23	◎ Letter to Enni	By Jianmen Miaoshen	Southern Song dynasty, China, dated 1249	Tokiwayama Bunko Foundation, Tokyo	①–④
27	◎ Nine-Panel Priest’s Robe	Owned by Yangqi Fanghui	Song dynasty, China, 10th–13th century	Tōfuku-ji Temple	①–④

No.	Title	Author etc.	Period / Century	Owner	Term
28	◎ Nine-Panel Priest's Robe	Owned by Poan Zuxian	Southern Song dynasty, China, 12th–13th century	Tōfuku-ji Temple	⑤–⑨
31	Priest's Ceremonial Fly Whisk ( <i>Hossu</i> ) with Carved Wooden Handle	Owned by Enni	Southern Song dynasty, China, 13th century	Tōfuku-ji Temple	
32	◎ Kujō Michiie	Inscription by Kenpō Shidon	Nanbokuchō period, dated 1343	Tōfuku-ji Temple	①–④
33	◎ Kujō Michiie	Inscription by Gyōchū Minshō	Muromachi period, dated 1423	Tōfuku-ji Temple	⑤–⑨
34	◎ Kujō Michiie's Deed of Transfer		Kamakura period, dated 1280	Tōfuku-ji Temple	①–④
35	◎ Record of Fumon-in Temple's Construction and Temple Estate		Kamakura period, 13th century	Tōfuku-ji Temple	⑤–⑨
36	◎ Fumon-in Temple Head Deed of Transfer	Signed by Enni	Kamakura period, dated 1280	Tōfuku-ji Temple	⑤–⑨
38	◎ Tōfuku-ji Temple Articles	Signed by Enni	Kamakura period, dated 1280	Tōfuku-ji Temple	①–④
39	◎ Death Verse (J. <i>Yuige</i> )	By Enni	Kamakura period, dated 1280	Tōfuku-ji Temple	⑤–⑨
42	The Chinese Characters for "Chokushi Shōichi Kokushi"	Attributed to Emperor Hanazono	Kamakura period, dated 1311	Tōfuku-ji Temple	
43	◎ Inventory of Enni's Estate	Signed by Kizan Ennen	Kamakura period, dated 1316	Tōfuku-ji Temple	⑤–⑨
44	Recorded Sayings of Shōichi Kokushi (Enni)		[1] Nanbokuchō–Muromachi period, 14th–16th century [2] Edo period, dated 1620	Tōfuku-ji Temple	①–④
45	Chronological Biography of Shōichi Kokushi (Enni)		Muromachi period, dated 1417	Reiun-in Temple, Kyoto	⑤–⑨

## Chapter 2: The Formation and Development of the Shōichi School

47	Implements for Esoteric Rituals	Purportedly owned by Enni	Kamakura–Muromachi period, 13th–15th century	Tōfuku-ji Temple	
48	Tōzan Tanshō		Muromachi period, 15th–16th century	Manju-ji Temple, Kyoto	①–④
49	Old Map of Sanshō-ji Temple		Kamakura–Nanbokuchō period, 14th century	Tōfuku-ji Temple	⑤–⑨
50	◎ Seated Figure in Priest Form		Kamakura period, 13th–14th century	Tōfuku-ji Temple	
53	Mukan Fumon	By Dharma Prince Dōkō	Edo period, dated 1659	Ryōgin-an Temple, Kyoto	⑤–⑨
55	◎ Hakuun Egyō		Kamakura period, 13th century	Rikkyoku-an Temple, Kyoto	①–④
56	◎ Hakuun Egyō		Kamakura–Nanbokuchō period, 14th century	Rikkyoku-an Temple, Kyoto	⑤–⑨
57	◎ Documents with Seals		Kamakura period, dated 1280	Rikkyoku-an Temple, Kyoto	Volume 2 ⑤–⑨ Volume 3 ①–④
58	◎ Wooden Seals: Hakuun, Egyō and Inkoku	Owned by Hakuun Egyō	Southern Song dynasty, China or Kamakura period, 13th century	Rikkyoku-an Temple, Kyoto	①–④
60	Nine-Panel Priest's Robe	Owned by Hakuun Egyō	Southern Song dynasty, China or Kamakura period, 13th century	Rikkyoku-an Temple, Kyoto	⑤–⑨
62	<i>Shitouzu</i> Socks	Owned by Hakuun Egyō	Kamakura period, 13th century	Rikkyoku-an Temple, Kyoto	⑤–⑨
63	◎ Sansō Eun	Inscription by Sansō Eun	Kamakura period, dated 1299	Shōgaku-an Temple, Kyoto	①–④
64	◎ Sansō Eun		Nanbokuchō–Muromachi period, 14th century	Shōgaku-an Temple, Kyoto	⑤–⑨
65	◎ Seated Zōzan Junkū		Kamakura period, 14th century	Yōmei-in Temple, Kyoto	
66	◎ Chikotsu Daie	Inscription by Chikotsu Daie	Kamakura period, dated 1301	Ganjō-ji Temple, Kyoto	①–④
67	◎ Death Verse (J. <i>Yuige</i> )	By Chikotsu Daie	Kamakura period, dated 1312	Ganjō-ji Temple, Kyoto	①–④
68	Seven-Panel Priest's Robe	Owned by Chikotsu Daie	Kamakura period, 13th–14th century	Anyō-ji Temple, Mie	①–④
69	<i>Jikitotsu</i> Robe	Owned by Chikotsu Daie	Kamakura period, 13th–14th century	Anyō-ji Temple, Mie	①–④
70	<i>Zudabukuro</i> Bag	Owned by Chikotsu Daie	Kamakura period, 13th–14th century	Anyō-ji Temple, Mie	①–④
71	◎ Sōhō Sōgen	Inscription by Sōhō Sōgen	Kamakura period, 14th century	Keishō-in Temple, Kyoto	⑤–⑨
72	Priest's Ceremonial Fly Whisk ( <i>Hossu</i> ) with Black-Lacquered Wooden Handle	Owned by Sōhō Sōgen	Kamakura period, 13th–14th century	Tōfuku-ji Temple	
73	◎ Kokan Shiren	Inscription by Kokan Shiren	Yuan dynasty, China, 14th century	Kaizō-in Temple, Kyoto	①–④
74	Kokan Shiren	Inscription by Kokan Shiren	Yuan dynasty, China, 14th century	Kaizō-in Temple, Kyoto	⑤–⑨

No.	Title	Author etc.	Period / Century	Owner	Term
75	◎ History of Buddhism Written in the Genkō Era (J. <i>Genkō Shakusho</i> )	By Kokan Shiren and others	Nanbokuchō period, 14th century	Tōfuku-ji Temple	Volume 1 and 2 ①–④ Volume 7 and 10 ⑤–⑨
76	◎ An Explication of Advancement in Learning (Ch. <i>Jinxuejie</i> ), Fragment	By Kokan Shiren	Kamakura–Nanbokuchō period, 14th century	Tōfuku-ji Temple	①–④
77	“Tiger” Written in Large Characters	By Kokan Shiren	Kamakura–Nanbokuchō period, 14th century	Reigen-in Temple, Kyoto	
82	Death Verse (J. <i>Yuige</i> )	By Daidō Ichii	Nanbokuchō period, dated 1370	Yōmei-in Temple, Kyoto	⑤–⑨
84	Three Priests (Enni, Zōzan Junkū and Daidō Ichii) in an Ensō Circle	Attributed to Kissan Minchō	Muromachi period, 14th–15th century	Tōfuku-ji Temple	
87	Seated Shōkai Reiken		Muromachi period, 15th century	Taikō-an Temple, Kyoto	

### Chapter 3: The Legendary Buddhist Painter Minchō

90	Minchō Self-Portrait (Copy)	By Sumiyoshi Hiroyuki	Edo period, dated 1785	Tōfuku-ji Temple	⑥–⑨
91	Minchō Self-Portrait (Copy)	By Sumiyoshi Hiroyuki	Edo period, dated 1774	Nanmei-in Temple, Kyoto	①–⑤
92	New Rules of Yōmei-in's Three Sub-temples		Nanbokuchō period, dated 1381	Yōmei-in Temple, Kyoto	①–⑤
94	◎ The Five Hundred Arhats	By Kissan Minchō	Nanbokuchō period, dated 1386	Tōfuku-ji Temple	from 1st to 15th hanging scrolls ①–③ from 16th to 30th hanging scrolls ④–⑥ from 31st to 45th hanging scrolls ⑦–⑨
95	◎ The Five Hundred Arhats	By Kanō Takanobu	Edo period, dated 1620	Tōfuku-ji Temple	46th hanging scroll ⑤⑥ 47th hanging scroll ⑦–⑨
96	◎ The Five Hundred Arhats	By Kissan Minchō	Nanbokuchō period, dated 1386	Nezu Museum, Tokyo	48th hanging scroll ①② 49th hanging scroll ③④
97	The Five Hundred Arhats (restoration copy)		Heisei era, dated 2018	Tōfuku-ji Temple	
98	◎ Address and Offering to Arhats	Addendum by Shōkai Reiken	Nanbokuchō period, dated 1374	Tōfuku-ji Temple	⑥–⑨
99	Old Scroll Rollers for <i>The Five Hundred Arhats</i>		Edo period, dated 1699 (old roller for the finished work); Nanbokuchō, dated 1386 (old roller for the sketches)	Tōfuku-ji Temple	①–⑤
100	The Five Hundred Arhats (sketches)	By Kissan Minchō	Nanbokuchō period, 14th century	Tōfuku-ji Temple	11th and 16th hanging scrolls ①–③ 46th and 50th hanging scrolls ④–⑥ 45th and 47th hanging scrolls ⑦–⑨
101	◎ Bodhidharma; Liu Haichen and Li Tieguai	By Kissan Minchō	Muromachi period, 15th century	Tōfuku-ji Temple	①–⑤
102	◎ Enni	By Kissan Minchō	Muromachi period, 15th century	Tōfuku-ji Temple	①–④
103	Hanshan and Shide	By Kissan Minchō	Muromachi period, 15th century	Tōfuku-ji Temple	⑥–⑨
104	◎ White-Robed Avalokiteshvara	By Kissan Minchō	Muromachi period, 15th century	Tōfuku-ji Temple	⑥–⑨
105	◎ The Thirty-Three Forms of Avalokiteshvara	By Kissan Minchō	Muromachi period, dated 1412	Tōfuku-ji Temple	Right 5th, left 10th and left 13th hanging scrolls ①–⑤ Central image, right 4th and left 9th hanging scrolls ⑥–⑨
107	◎ Shōkai Reiken	Inscription by Shōkai Reiken	Nanbokuchō period, dated 1379	Taikō-an Temple, Kyoto	⑥–⑨
108	◎ Zōzan Junkū	By Kissan Minchō	Muromachi period, 15th century	Yōmei-in Temple, Kyoto	⑥–⑨
109	Zōzan Junkū	Inscription by Daigu Shōchi	Muromachi period, 15th century	Yōmei-in Temple, Kyoto	
110	◎ Zaisen Kijō	By Kissan Minchō; inscription by Zaisen Kijō	Muromachi period, 14th–15th century	Reigen-in Temple, Kyoto	①–⑤
111	◎ Zaisan Soei	By Kissan Minchō; inscription by Chūhō En'ī	Muromachi period, dated 1406	Tōfuku-ji Temple	⑥–⑨
112	◎ Giyō Hōshū	Inscription by Giyō Hōshū	Muromachi period, dated 1420	Reiun-in Temple, Kyoto	①–⑤
113	◎ The Forty Patriarchs	By Kissan Minchō	Muromachi period, dated 1427	Tōfuku-ji Temple	①–⑤

### Chapter 4: Zen Culture and International Exchanges

114	Enni		Southern Song dynasty, China, 13th century	Tōfuku-ji Temple	①–⑤
115	◎ Inventory of Fumon-in Temple Treasures	Signed by Kizan Ennen	Kamakura period, dated 1316	Tōfuku-ji Temple	⑥–⑨

No.	Title	Author etc.	Period / Century	Owner	Term
116	◎ Inventory of Fumon-in Temple Books	By Daidō Ichii and others	Kamakura–Nanbokuchō period, 14th century	Tōfuku-ji Temple	①–⑤
117	● Imperial Readings of the Taiping Era (Ch. <i>Taiping yulan</i> )		Southern Song dynasty, China, 12th–13th century	Tōfuku-ji Temple	Inventory 1 and Volume 75 ①–⑤ Inventory 2 and Volume 79 ⑥–⑨
118	● Travel Diary of the Priest Yichu (Ch. <i>Yichu liutie</i> )		Southern Song dynasty, China, 12th–13th century	Tōfuku-ji Temple	Volume 1 and 3 ①–⑤ Volume 4 and 10 ⑥–⑨
119	◎ Lankavatara Sutra (Su Shi Transcription)	Original by Su Shi	Northern Song–Southern Song dynasty, China, 11th–12th century	Tōfuku-ji Temple	①–⑤
120	◎ Extracts from the Fourfold Vinaya Rules for Buddhist Nuns (Ch. <i>Sifenlu biqiuni chao</i> )		Southern Song dynasty, China, dated 1207	Tōfuku-ji Temple	⑥–⑨
121	Song Biographies of Eminent Monks (Ch. <i>Song gaoseng zhuan</i> )		Southern Song dynasty, China, 12th–13th century	Tōfuku-ji Temple	
122	◎ Record of the Light of the Buddhist Law (Ch. <i>Fofa daming lu</i> )		Southern Song dynasty, China, 12th–13th century	Reiun-in Temple, Kyoto	⑥–⑨
123	◎ Recorded Sayings of the Zen Master Yuanwu		Southern Song dynasty, China, 12th–13th century	Tōfuku-ji Temple	①–⑤
124	◎ Record of the Priest Jōjin's Pilgrimage to Mount Tiantai and Mount Wutai (J. <i>San Tendai Godaisan ki</i> )		Heian period, dated 1171	Tōfuku-ji Temple	⑥–⑨
125	◎ Collected Sutras of Tōfuku-ji Temple History of Buddhism Written in the Genkō Era Avatamsaka Sutra, Vol.30		Southern Song dynasty, China, dated 1151 Nanbokuchō period, dated 1384	Tōfuku-ji Temple	①–⑤ ⑥–⑨
126	◎ World Map		Southern Song dynasty, China, 13th century	Rikkyoku-an Temple, Kyoto	①–③
127	“Esteeming Old Age and Venerating Longevity”; “Accumulating Good Deeds and Spreading Merit”	Attributed to Su Shi	Southern Song dynasty, China, 13th century	Tōfuku-ji Temple	①–⑤
128	“Eschew Evil Deeds”; “Practice Good Deeds”	By Zhang Jizhi	Southern Song dynasty, China, 13th century	Tōfuku-ji Temple	⑥–⑨
129	◎ “Mount Taibai” Written in Four Large Characters	By Emperor Xiaozong	Southern Song dynasty, China, dated 1178	Tōfuku-ji Temple	①–③
130	◎ Poetic Verse in Praise of Venerable Lingying (Shi Deguang)	By Emperor Xiaozong	Southern Song dynasty, China, dated 1181	Tōfuku-ji Temple	①–⑤
131	◎ Questions Asked to Zen Master Shi Deguang	By Emperor Xiaozong	Southern Song dynasty, China, dated 1181	Tōfuku-ji Temple	①–⑤
132	◎ Words in Praise of Zen Master Shi Deguang	By Emperor Xiaozong	Southern Song dynasty, China, dated 1181	Tōfuku-ji Temple	⑥–⑨
133	◎ Record of the New Monastic Hall at Jingde Temple on Mount Tiantong in Ming Province	By Hongzhi Zhengjue	Southern Song dynasty, China, dated 1142	Tōfuku-ji Temple	⑥–⑨
134	◎ Biography of the Saint Mingjue (J. Myōkaku Daishi)	By Jiang Can	Southern Song dynasty, China, dated 1202	Tōfuku-ji Temple	④–⑥
135	◎ Record of Sutra Transcriptions of the Fujiwara Minister of Japan	By Xiyian Liaohui	Southern Song dynasty, China, dated 1255	Tōfuku-ji Temple	⑦–⑨
136	Inverted Left Calligraphy “Longevity and Happiness”; “Tranquility”	Attributed to Wuan Puning	Kamakura period, 13th century	Tōfuku-ji Temple	④–⑨
137	Sakyamuni Triad		Yuan dynasty, China, 13th–14th century	Yōmei-in Temple, Kyoto	①–⑤
138	◎ Sakyamuni Triad	Attributed to Wu Daozi	Yuan dynasty, China, 14th century	Tōfuku-ji Temple	⑥–⑨
139	◎ Vimalakirti		Southern Song–Yuan dynasty, China, 13th–14th century	Tōfuku-ji Temple	⑥–⑨
141	The Sixteen Arhats		Ming dynasty, China, 15th–16th century	Yōmei-in Temple, Kyoto	①–⑤
142	Avalokiteshvara (K. Gwaneum Bosal)	Attributed to Wu Daozi	Goryeo period, Korea, 13th–14th century	Tōfuku-ji Temple	⑥–⑨
143	◎ Death of the Buddha with Phases of the Buddha's Life		Kamakura period, 13th century	Manju-ji Temple, Kyoto	⑥–⑨
144	Eighteen Devas		Kamakura–Nanbokuchō period, 14th century	Yōmei-in Temple, Kyoto	①–⑤

No.	Title	Author etc.	Period / Century	Owner	Term
145	◎ Yingan Tanhua	Inscription by Nanjū Shigō	Nanbokuchō period, dated 1390	Tōfuku-ji Temple	①–⑤
146	◎ Sakyamuni Triad	By Ryōzen	Nanbokuchō period, 14th century	Kiyoshikōjin Seichō-ji Temple, Hyogo	⑥–⑨
147	◎ The Sixteen Arhats	By Ryōzen	Nanbokuchō period, 14th century	Kennin-ji Temple, Kyoto	①–⑤
148	◎ Sakyamuni Descending from the Mountain; Plum Blossoms	Inscription by Hakuun Egyō	Kamakura period (center and righthand scrolls); Southern Song dynasty, China (lefthand scroll), 13th century	Rikyoku-an Temple, Kyoto	⑥–⑨
149	Samantabhadra (J. Fugen Bosatsu)	Inscription by Zōzan Junkū	Kamakura period, dated 1307	Yōmei-in Temple, Kyoto	⑥–⑨
150	◎ Sakyamuni Triad	By Gukei	Nanbokuchō period, 14th century	Manju-ji Temple, Kyoto	①–⑤
151	White-Robed Avalokiteshvara	Attributed to Muqi	Nanbokuchō period, 14th century	Tōfuku-ji Temple	⑥–⑨
152	Avalokiteshvara on a Lotus Leaf (Ichiyō Kannon)	Inscription by Yoka Shinkō; By Keishaku	Muromachi period, dated 1429	Nezu Museum, Tokyo	③④
153	White-Robed Avalokiteshvara	Attributed to Kissan Minchō	Muromachi period, 15th century	Shōrin-ji Temple, Kyoto	①–⑤
154	White-Robed Avalokiteshvara	By Sekkyaku Shi	Muromachi period, 15th century	Nezu Museum, Tokyo	①②
155	◎ Manjusri (J. Monju Bosatsu) Riding a Lion	By Reisai; inscription by Ryōkō Shinkei	Muromachi period, 15th century	Tokyo National Museum	①–⑤
156	Tenjin Who Visited China (J. Totō Tenjin)	Inscription by Kentei	Muromachi period, dated 1444	Tōfuku-ji Temple	
158	Chanted Poems on the Ise Civil War	By Shinchū Mintoku and others	Muromachi period, dated 1429	Yōmei-in Temple, Kyoto	⑤–⑨
164	Eared Censer, with design of flowers and ornamental plants	Excavated from Zōzan Junkū's stone burial chamber	Yuan dynasty, China, 13th–14th century	Yōmei-in Temple, Kyoto	
172	Stands for <i>Tenmoku</i> Bowls, with applied foil design (tortoiseshell <i>Tenmokudai</i> )		Azuchi-Momoyama–Edo period, 16th–17th century	Tōfuku-ji Temple	

## Chapter 5: Tōfuku-ji's Monumental Buildings and Buddhist Sculptures

174	◎ Tōfuku-ji Temple	Inscription by Ryōan Keigo	Muromachi period, dated 1505	Tōfuku-ji Temple	⑥–⑨
175	The Origins of Tōfuku-ji Temple		Edo period, 17th century	Tōfuku-ji Temple	
176	Map of Tōfuku-ji Temple's Head Temple and Sub-Temples		Edo period, 19th century	Tōfuku-ji Temple	①–⑤
178	● Calligraphic Frames and Plates for Zen Temples	By Wuzhun Shifan and Zhang Jizhi	Southern Song dynasty, China, 13th century	Tōfuku-ji Temple	Chokushi Jōtenzen-ji, Daiengaku and Hōjō ①–⑤ Fumon-in and Shuso ⑥–⑨ Shoki, Shika, Sendanrin, Jōdō and Sekkai ①–③ Inō, Yokusu, Gekūshitsu, Shōsan and Fusetu ④–⑥ Zengo, Sannō, Tōzaijō and Hinpotsu ⑦–⑨
179	◎ Framed Calligraphy for Zen Temple: "Buddhist Sanctum"	By Wuzhun Shifan	Southern Song dynasty, China, 13th century	Tokyo National Museum	⑥–⑨
180	◎ Calligraphic Plate for Zen Temple: "Worship Route"	By Wuzhun Shifan	Southern Song dynasty, China, 13th century	Tokiyayama Bunko Foundation, Tokyo	⑦–⑨
181	Fragment of Calligraphic Plate for Zen Temple: "Honey Water"	By Wuzhun Shifan	Southern Song dynasty, China, 13th century	Tokyo National Museum	④–⑥
182	● Inventory of Framed Calligraphy by Wuzhun Shifan	Signed by Kizan Ennen	Kamakura period, dated 1316	Tōfuku-ji Temple	①–③
183	Calligraphy for a Zen Temple Sign: "Meditation Hall"	Original by Wuzhun Shifan	Azuchi-Momoyama–Edo period, 16th–17th century	Tōfuku-ji Temple	①–⑤
184	Calligraphic Plate for Zen Temple: "Worship Route"	Original by Wuzhun Shifan	Azuchi-Momoyama–Edo period, 16th–17th century	Tōfuku-ji Temple	⑦–⑨
185	Temple Hall Plaque "Sendanrin Dormitory"	Original by Zhang Jizhi	Muromachi period, 14th–15th century	Tōfuku-ji Temple	
186	Calligraphy for a Zen Temple Plaque: "Masters's Ascendance to the Hall"	Original by Wuzhun Shifan	Edo period, 17th century	Tōfuku-ji Temple	
187	◎ Diagram of Song-Dynasty Zen Temples		Southern Song dynasty, China, 13th century	Tōfuku-ji Temple	⑥–⑨
188	Diagram of Song-Dynasty Zen Temples		Edo period, 18th century	Tōfuku-ji Temple	①–⑤
191	◎ Sutra Boards for Shushō-e Ceremony at Tōfuku-ji Temple	By Kozan Ikkyō	Nanbokuchō period, 14th century	Tōfuku-ji Temple	Volume 1 ①–⑤ Volume 2 ⑥–⑨

No.	Title	Author etc.	Period / Century	Owner	Term
195	Framed Calligraphy: "Pavilion"	By Ashikaga Yoshimochi	Muromachi period, 15th century	Tōfuku-ji Temple	⑥-⑨
197	◎ <i>Maejoku</i> Altar, with peony, arabesque and openwork design		Nanbokuchō period, 14th century	Tōfuku-ji Temple	
198	Seated Sakyamuni (from mandorla)	From the former principal image of Tōfuku-ji Temple	Kamakura-Nanbokuchō period, 14th century	Nanmei-in Temple, Kyoto	
199	Lotus Petal	From the former principal image of Tōfuku-ji Temple	Kamakura-Nanbokuchō period, 14th century	Sokushū-in Temple, Kyoto	
200	Buddha's Hand	From the former principal image of Tōfuku-ji Temple	Kamakura-Nanbokuchō period, 14th century	Tōfuku-ji Temple	
201	◎ Standing Kasyapa (J. Kashō) and Ananda (J. Anan)		Kamakura period, 13th century	Tōfuku-ji Temple	
202	Standing Four Heavenly Kings		Kamakura period, 13th century	Tōfuku-ji Temple	
203	Seated Brahma (J. Bonten)		Muromachi period, 15th century	Tōfuku-ji Temple	
204	Standing Garanjin (tutelary deities)	By Jōyū	Muromachi period, dated 1441	Tōfuku-ji Temple	
205	◎ Standing Vajradhara (J. Kongō Rikishi)		Kamakura period, 13th century	Manju-ji Temple, Kyoto	
206	◎ Standing Two Heavenly Kings		Kamakura period, 13th century	Tōfuku-ji Temple	
207	◎ Seated Ksitigarbha (J. Jizō Bosatsu)		Kamakura period, 13th century	Tōfuku-ji Temple	
208	Seated Sakyamuni with Jeweled Crown		Nanbokuchō-Muromachi period, 14th-15th century	Sokushū-in Temple, Kyoto	

## Floor Plan | Heiseikan 2F

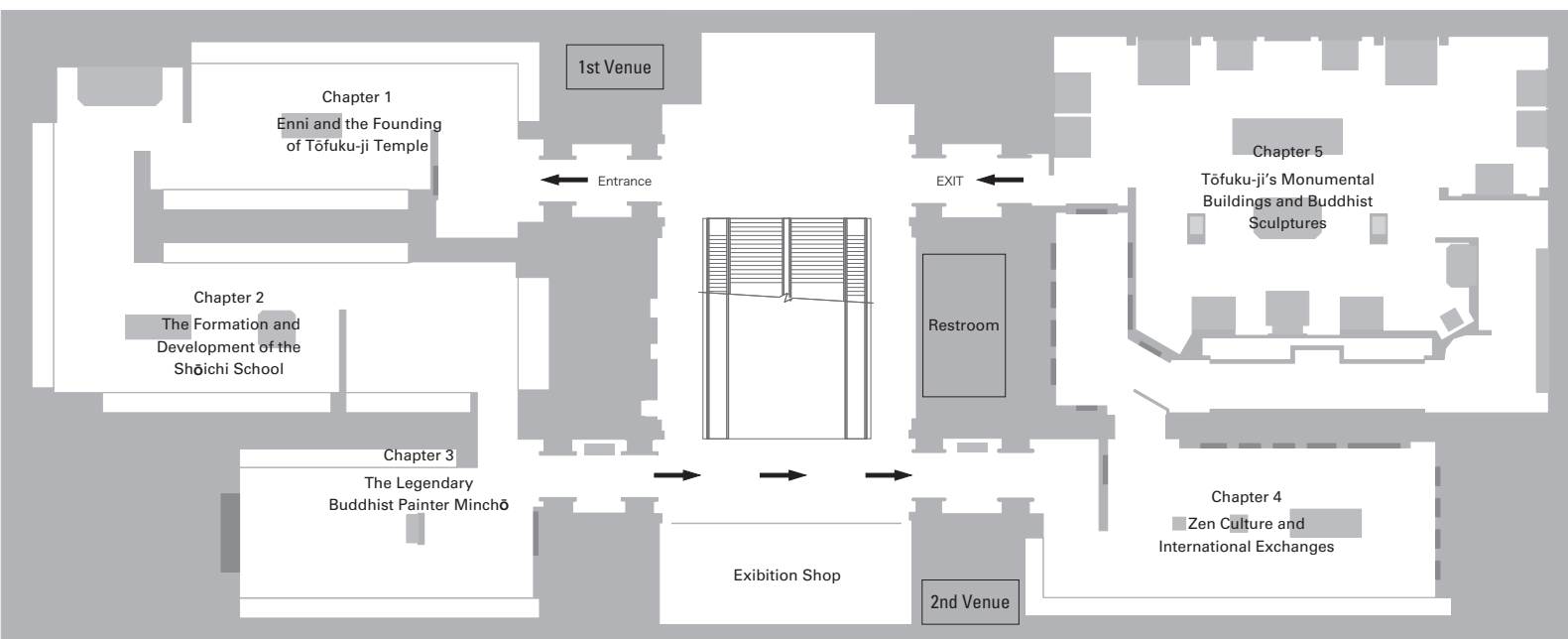

\* Temperature, humidity and brightness of the exhibition rooms are strictly controlled under international standards for preservation. We apologize for any inconvenience this may cause.

